

# WEDNESDAY EVENING

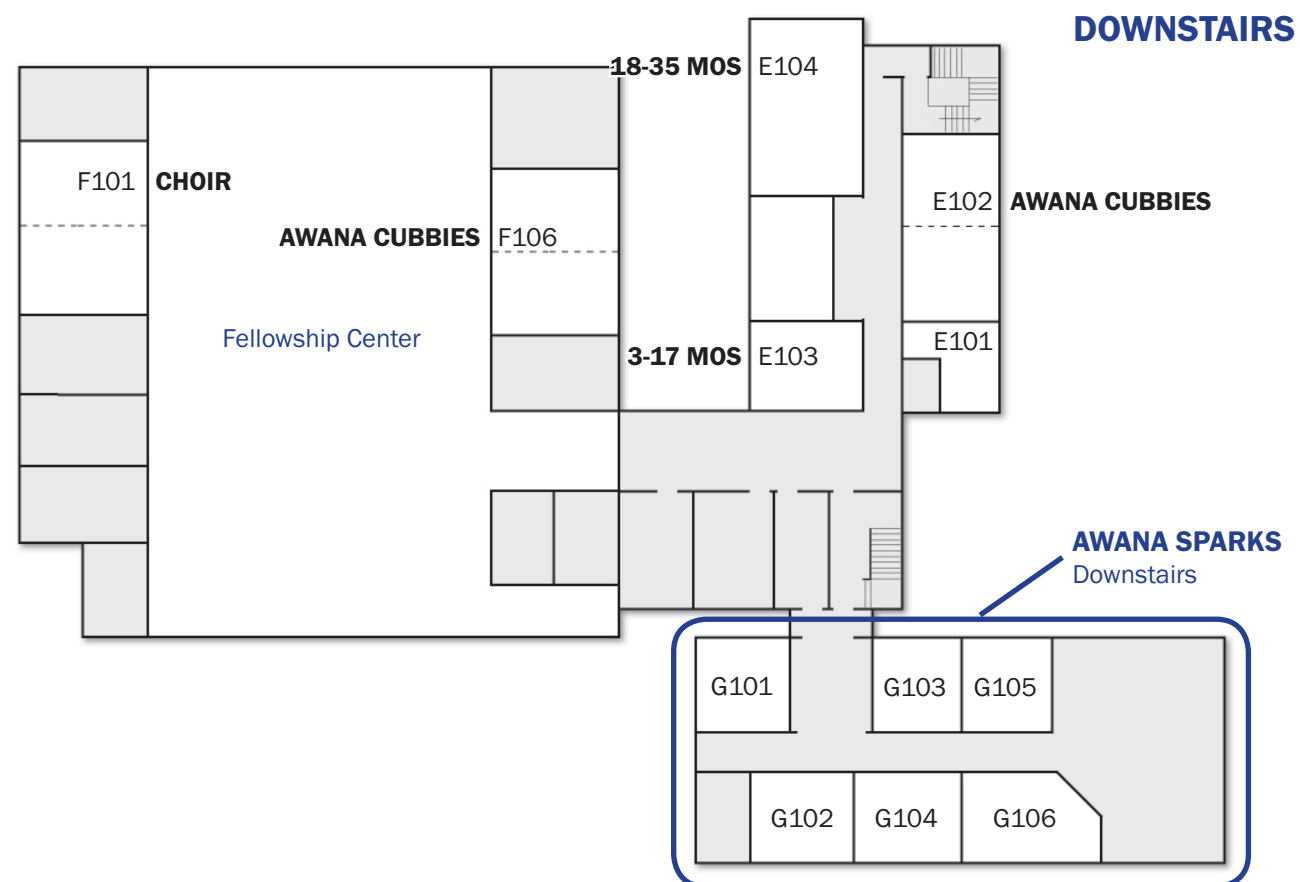
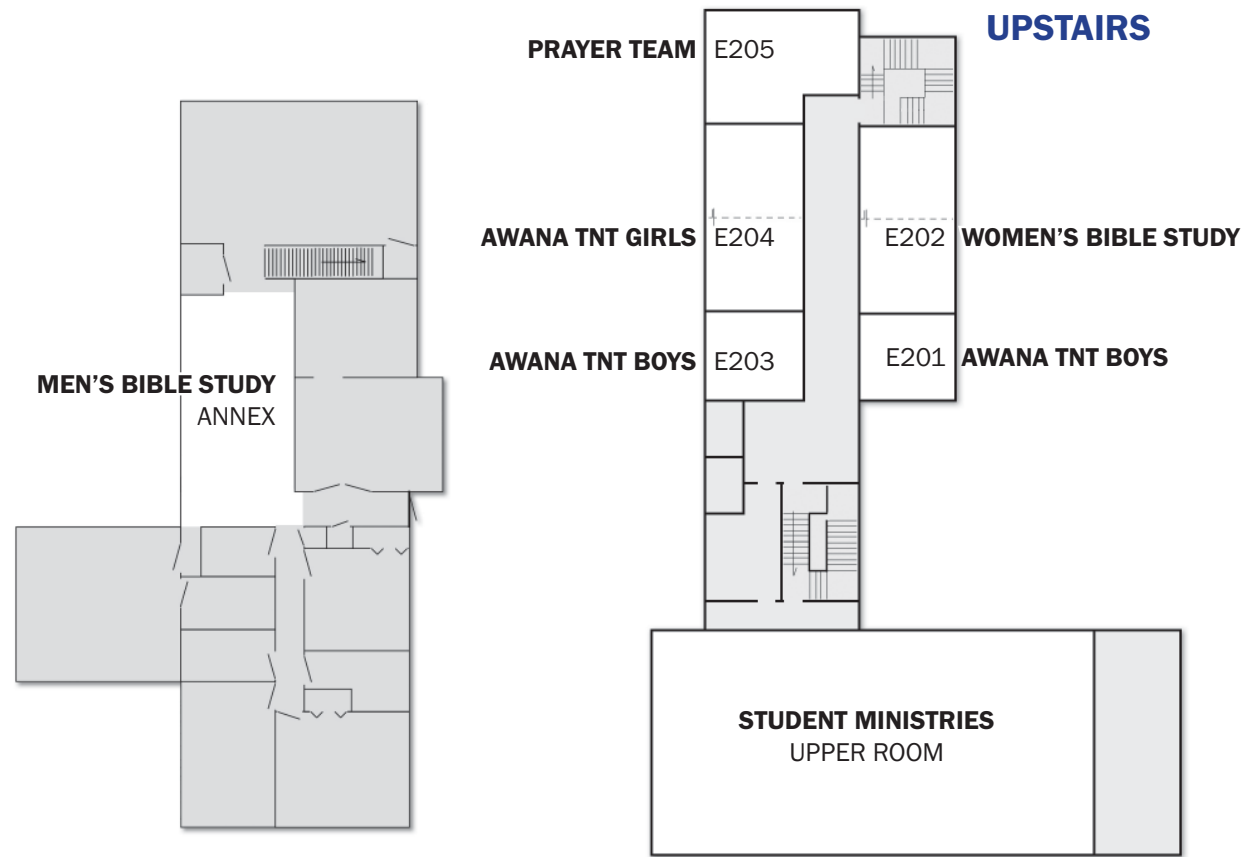

## COMMUNITY BIBLE CHURCH FACILITY TRANSITION PLAN

As CBC continues to grow, we have been presented with the challenge of evaluating and implementing necessary changes to how we can best utilize the space we have.

Our goal is to double the available space for Children's ministry classes. The following pages contain the details and maps for how we've moved things around to maximize use of our space.

### SUNDAY MORNING

**Nursery** will expand to occupy the entire first floor of the Equipping Center. The age range will begin at 3 months through 29 months.

**Preschool** will remain downstairs. However, the age range will change to now include 30 months through pre-kindergarten.

**Elementary** age children will now occupy the second floor of the Equipping Center. Children entering Kindergarten in the Fall will now be part of this department.

**Student Ministries** will move to the Annex for Sunday School, but will remain in the Upper Room on Wednesday nights.

**Adult Ministry** will offer two Sunday school classes each hour.

**The Connecting Class** will now meet in the second hour.

Please refer to the maps on the following pages for more details.

### WEDNESDAY NIGHT

We have a special map included to show where everybody will be on our busiest night of the week.

**SUNDAY MORNING FIRST HOUR - 9:00 - 10:15 AM**

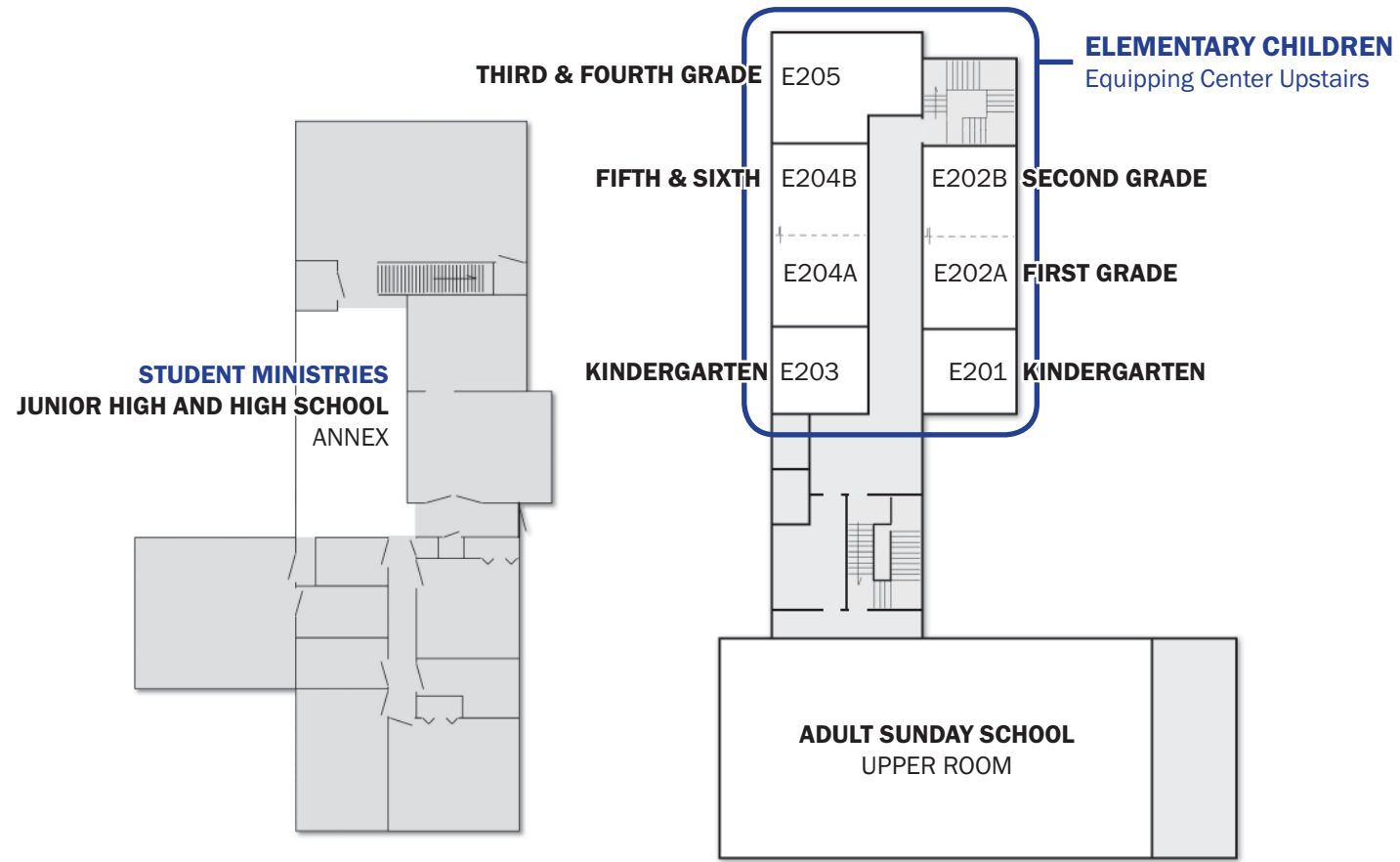

**SUNDAY MORNING SECOND HOUR - 10:45 AM - NOON**

